



90 ELBOW (BF) SDR 11/17, PE2708/PE4710

90 ELBOW (BF) DIMENSION SHEET

- Manufactured in accordance with AWWA C901 & C906, ASTM D2513 & D3261 & D3350
- Certified to NSF/ANSI 61 and NSF/ANSI-372
- Produced by using a resin listed on the PPI TR-4
- Produced by Injection Molding
- Suitable for Water, Gaseous, Fluids and Slurries
- Excellent chemical resistance and corrosion resistance

(at 73.4°F)

GRADE	Gas		Industrial	
	SDR17	SDR11	SDR17	SDR11
2708	62.5 psi	100 psi	100 psi	160 psi
4710	80 psi	125 psi	125 psi	200 psi

Unit : inch

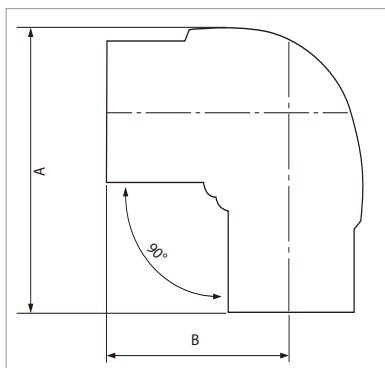

DN	SDR	BF 90 ELBOW		Weight (lbs.)	Type	Item Code	
		A	B			Gas	Industrial
1/2" CTS	11	1.535	1.063	0.02	Injection (Socket)	COSB GCI0100	COSB WCI0100
1/2" IPS	11	1.693	1.142	0.05	Injection (Socket)	COSB GCI0101	COSB WCI0101
3/4" IPS	11	2.087	1.417	0.07	Injection (Socket)	COSB GCI0102	COSB WCI0102
1" IPS	11	2.441	1.614	0.11	Injection (Socket)	COSB GCI0104	COSB WCI0104
1 1/4" IPS	11	2.913	1.890	0.19	Injection (Socket)	COSB GCI0105	COSB WCI0105
1 1/2" IPS	11	3.425	2.205	0.30	Injection (Socket)	COSB GCI0106	COSB WCI0106
2" IPS	11	4.134	2.598	0.58	Injection (Socket)	COSB GCI0107	COSB WCI0107
2 1/2" IPS	11	4.754	2.913	0.90	Injection (Socket)	COSB GCI0108	COSB WCI0108
2" IPS	11	5.717	4.472	0.78	Injection (Butt)	COSB GI0102	COSB WI0102
3" IPS	11	7.874	6.102	1.70	Injection (Butt)	COSB GI0103	COSB WI0103
4" IPS	11	8.661	6.496	2.56	Injection (Butt)	COSB GI0104	COSB WI0104
6" IPS	11	11.614	8.465	6.24	Injection (Butt)	COSB GI0105	COSB WI0105
8" IPS	11	15.197	10.748	18.03	Injection (Butt)	COSB GI0106	COSB WI0106
16" IPS	11	23.307	10.748	84.13	Injection (Butt)	COSB GI0110	COSB WI0110

The product dimensions may change for quality improvement by manufacturer

