

# 45 ELBOW (BF)

SDR 11/17, PE2708/PE4710



COSMOIND USA

45 ELBOW (BF) DIMENSION SHEET

- Manufactured in accordance with AWWA C901 & C906, ASTM D2513 & D3261 & D3350
- Certified to NSF/ANSI 61 and NSF/ANSI-372
- Produced by using a resin listed on the PPI TR-4
- Produced by Injection Molding
- Suitable for Water, Gaseous, Fluids and Slurries
- Excellent chemical resistance and corrosion resistance

(at 73.4 °F)

GRADE	Gas		Industrial	
	SDR17	SDR11	SDR17	SDR11
2708	62.5 psi	100 psi	100 psi	160 psi
4710	80 psi	125 psi	125 psi	200 psi

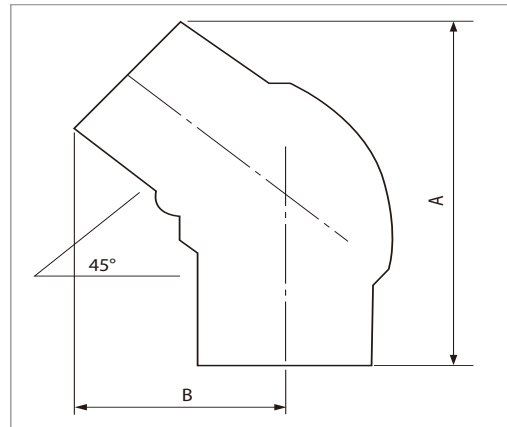

Unit : inch

DN	SDR	BF 45 ELBOW		Weight (lbs.)	Type	Item Code	
		A	B			Gas	Industrial
4" IPS	11	9.843	5.709	2.05	Injection (Butt)	COSB GI0202	COSB WI0202
6" IPS	11	13.780	6.693	5.60	Injection (Butt)	COSB GI0203	COSB WI0203
16" IPS	11	22.992	12.283	63.32	Injection (Butt)	COSB GI0208	COSB WI0208

The product dimensions may change for quality improvement by manufacturer